



TA MODELS

1024, 1038, 1238, 1530

REPLACEMENT PARTS

Reference

When selecting and ordering parts, always refer to serial numbers on the name plate.

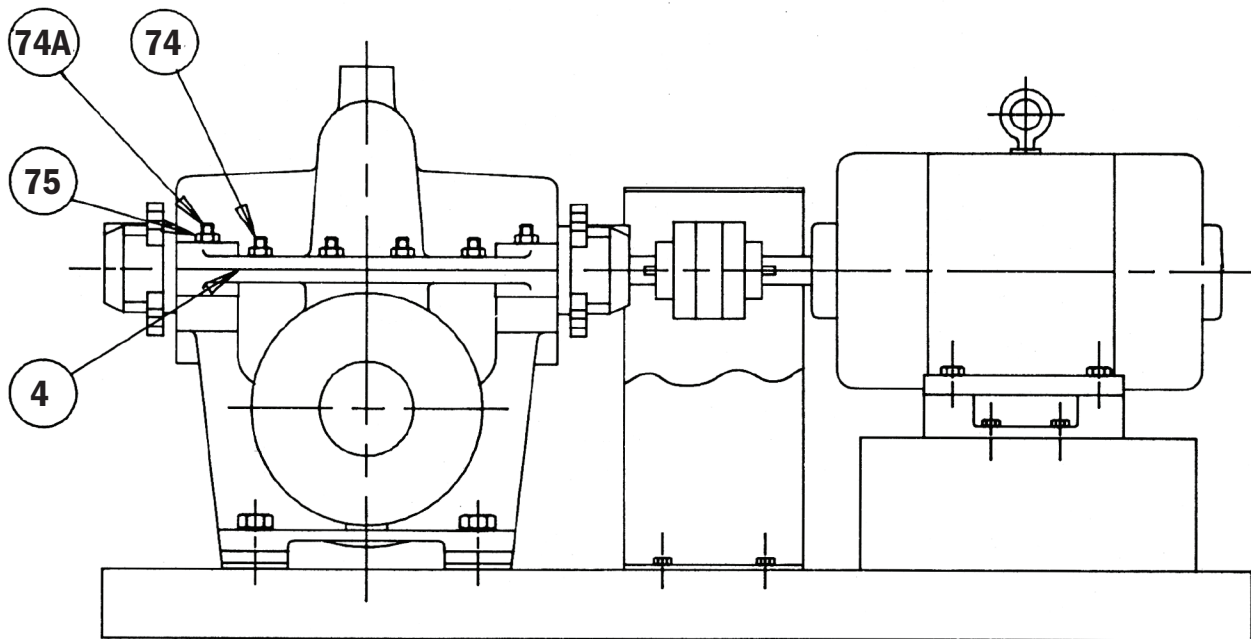
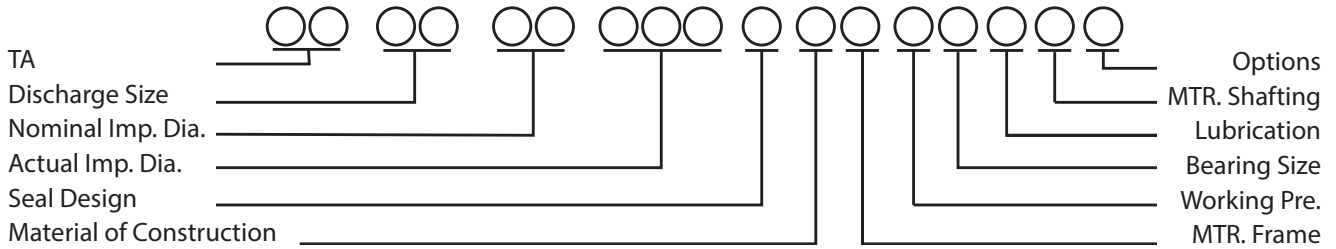

TA Series Horizontal Split Case Pumps

Mechanical Seal Parts & Internal Parts

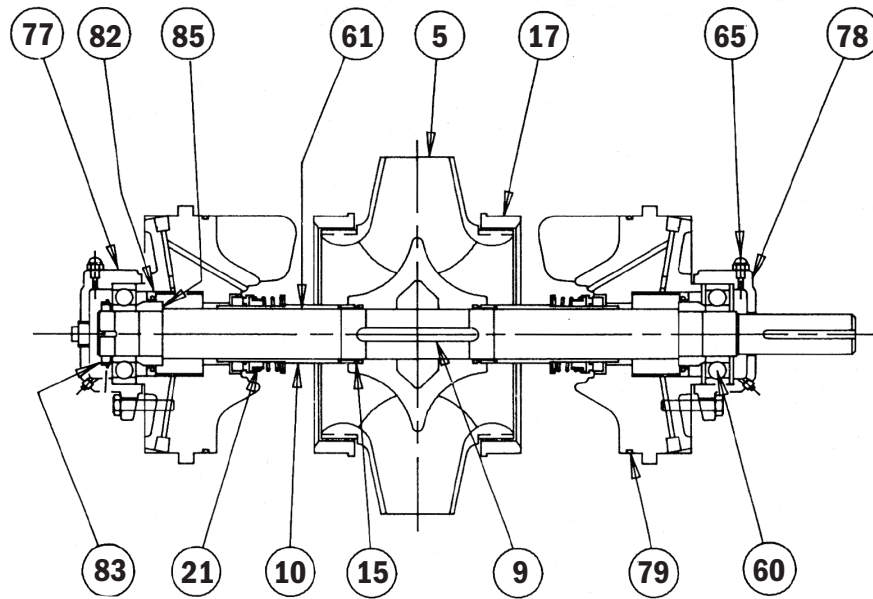

Item No.	Qty.	ID No.	Part Number	Description	PUMP MODEL NUMBER				Remarks
					1024	1038	1238	1530	
4	1	11	951-410RP	Casing Gasket Set	X				
4	1	16	951-406RP	Casing Gasket Set		X			
4	1	17	951-408RP	Casing Gasket Set			X		
4	1	13	951-400RP	Casing Gasket Set				X	
5	1	11	950-1229BRP	Bronze Impeller					
5	1	16	950-1234BRP	Bronze Impeller	X				
5	1	17	950-1235BRP	Bronze Impeller		X			
5	1	13	950-1231BRP	Bronze Impeller			X		
9	1	3	950-1243BRP	Impeller Key				X	
10	2	8	950-1248BRP	Bronze Sleeve					
10	2	8	951-159RP	Stainless Steel Sleeve	X	X	X	X	
15	2	2	951-177RP	Sleeve "O" Ring	X	X	X	X	
17	2	4	950-1254BRP	Bronze Wear Ring	X	X	X	X	
17	2	6	950-1256BRP	Bronze Wear Ring	X	X	X	X	
21	2	2	950-674RP	Standard Water Seal	X	X			
21	2	2	950-677RP	Hi-Temp Water Seal			X	X	
21	2	2	950-680RP	Ceramic Water Seal	X	X	X	X	*
60	2	2	950-963RP	Ball Bearing	X	X	X	X	*
61	1	3	950-1266RP	Shaft (Stl.)	X	X	X	X	*
61	1	3	950-1266RP	Shaft (S.S.)	X	X	X	X	

*Select seal per code on pump nameplate.

Mechanical Seal Parts & Internal Parts (continued)

Item No.	Qty.	ID No.	Part Number	Description	PUMP MODEL NUMBER				Remarks
					1024	1038	1238	1530	
65	2	1	950-1214RP	Grease Fitting	X	X	X	X	
74		2	950-1270RP	Casing Studs	17/X	21/X			**
74		3	950-1271RP	Casing Studs			19/X	16/X	**
74A	4	11	950-1275RP	Casing Studs	X	X			
74A	4	12	950-1276RP	Casing Studs			X	X	
75		1	950-1279RP	Casing Nuts	21/X	25/X			**
75		2	950-1280RP	Casing Nuts			23/X	20/X	**
77	1	2	950-1283RP	Bearing Housing (NDE)	X	X	X	X	
78	1	2	950-1286RP	Bearing Housing (DE)	X	X	X	X	
79	2		950-965RP	"O" Ring	X	X			
79	2		950-966RP	"O" Ring			X	X	
82	2	2	950-1290RP	Oil Seal	X	X	X	X	
83	1	2	950-1293RP	Nut Bearing Retainer	X	X	X	X	
85	2	2	950-1296RP	Shoulder Ring	X	X	X	X	
	1		951-1853RP	(CW) Rotating Elem. Assembly	X				*
	1		951-1854RP	(CW) Rotating Elem. Assembly		X			*
	1		951-18550RP	(CW) Rotating Elem. Assembly			X		*
	1		951-1856RP	(CW) Rotating Elem. Assembly				X	*
	1		951-1875RP	(CCW) Rotating Elem. Assembly	X				*
	1		951-1876R	(CCW) Rotating Elem. Assembly		X			*
	1		951-1877R	(CCW) Rotating Elem. Assembly			X		*
	1		951-1878R	(CCW) Rotating Elem. Assembly				X	*

** Number shown are quantities required. "X" is for pump model.

All bolts, lockwashers, plugs and coupler guard screws are hardware items.

*Impeller diameter must be specified.

*Bronze impeller and sleeve, carbon steel shaft and standard ni-resist seals.