

# Submittal Data Information

## Potable Water Zone Sentry® (≤ 25% Lead)

101-160

Effective: October 25, 2017

Supersedes: May 30, 2016

Job: \_\_\_\_\_ Engineer: \_\_\_\_\_ Contractor: \_\_\_\_\_ Rep: \_\_\_\_\_

ITEM NO.	MODEL NO.	



### Application:

The Taco Potable Water Zone Sentry zone valve is available in a 2-way sweat configuration with either a normally open or normally closed actuator. Some typical installations would include a combination domestic water and hydronic heating system, culinary installation or water shut off to a potable system.

For Indoor Use Only

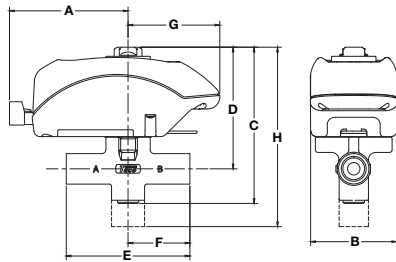

### Product Specifications

Max. Operating Pressure.....	300 PSI (2100 kPa)
Max. Shutoff Pressure.....	125 PSI (875 kPa)
Fluid Temp. Range .....	33-220°F (1°-104°C)
Service .....	Potable Water
Ball Rotation Speed.....	(90° turn), Approx. 5 seconds (After charge time)
Electrical Rating .....	24 VAC, 60Hz, 0.48 Amps
Power Consumption .....	11.4 W, 0.48 Amps (Charging)
Power Consumption .....	1.44W, 0.06 Amps (Power On)
End Switch Rating.....	1 Amp @ 24 VAC

### Materials of Construction

<b>Actuator:</b>	
Body.....	High Performance Engineered Polymer
Gears.....	High Performance Internally Lubricated Engineered Polymer
<b>Valve:</b>	
Body.....	Forged Brass
Stem.....	Brass
Press Ring.....	Brass
Ball.....	Brass (Chrome Plated)
Seat.....	Modified Teflon®
O-Rings.....	Viton

### Potable Water Zone Sentry® Dimensions: (FOR REFERENCE PURPOSES)

Part Number	Valve Size	Valve Type	A		B		C		D		E		F		G	
			in.	mm	in.	mm	in.	mm	in.	mm	in.	mm	in.	mm	in.	mm
V050C2D2ZA024Q4A1 (Normally Closed)	1/2"	2-way Sweat	3"	76.2	2.375"	60.3	4.125"	104.7	3.06"	77.72	3.125"	79.3	1.562"	39.7	2.312"	58.7
V075C2D2ZA024Q4A1 (Normally Closed)	3/4"	2-way Sweat	3"	76.2	2.375"	60.3	4.125"	104.7	3.12"	79.25	3.125"	79.3	1.562"	39.7	2.312"	58.7
V050C2D2ZB024Q4A1 (Normally Open)	1/2"	2-way Sweat	3"	76.2	2.375"	60.3	4.125"	104.7	3.06"	77.72	3.125"	79.3	1.562"	39.7	2.312"	58.7
V075C2D2ZB024Q4A1 (Normally Open)	3/4"	2-way Sweat	3"	76.2	2.375"	60.3	4.125"	104.7	3.12"	79.25	3.125"	79.3	1.562"	39.7	2.312"	58.7

Valve Size	Cv (Kv) / Ft. of Pipe Equiv.**	Close-Off Pressure (kPa)
1/2"	4.9 (4.3) / 9.5	0-125 psi (0-862 kPa)
3/4"	10.3 (8.9) / 8.4	0-125 psi (0-862 kPa)

\*\*At 4' per second (Max. recommended residential flow rate)

