



Submittal Data Information

101-077

Model 007-IFC® Cartridge Circulator

Effective: November 24, 2024

Supersedes: June 7, 2010

Job: _____ Engineer: _____ Contractor: _____ Rep: _____

ITEM NO.	MODEL NO.	IMP. DIA.	G.P.M.	HEAD/FT.	H.P.	ELEC. CHAR.

Features

- Integral Flow Check (IFC®)
 - Simplifies piping
 - Prevents reverse flow and gravity flow
 - Eliminates separate in-line flow check
 - Reduces installed cost
 - Improves system performance
 - Easy to service
- Unique replaceable cartridge-field serviceable
- Unmatched reliability-maintenance free
- Quiet, efficient operation
- Self lubricating, No mechanical seal
- Wide range of applications
- Cast Iron or Stainless Steel construction
- Flanged connections

Application

- Hydronic Heating/Cooling
- Radiant
- Indirect Water Heaters
- Hydro-Air Fan Coils
- Domestic Water Recirculation (Stainless Steel only)

The 007-IFC is designed to simplify piping, reduce installation costs and improve system performance when zoning with 00® circulators. By locating the IFC inside the pump, a separate in-line flow check is eliminated. The low pressure drop of the IFC increases flow performance vs. in-line flow checks. Both the IFC and the cartridge are easily accessed for removal and service.

Pump Dimensions & Weights

Model	Casing	in.	mm	in.	mm	in.	mm	in.	mm	in.	mm	in.	mm	lbs.	Kg
007-F5-7 IFC	Cast Iron	6-1/8	156	4-1/2	114	3-3/16	81	2-15/16	75	5	127	6-3/8	162	9	4.0
007-F5-8 IFC	Cast Iron	5-7/8	149	4-1/2	114	3-3/16	81	2-15/16	75	5	127	6-3/8	162	9	4.0
007-SF5 IFC	S.Steel	6-1/8	156	4-1/2	114	3-3/16	81	2-15/16	75	5	127	6-3/8	162	9	4.0

Materials of Construction

Casing (Volute): Cast Iron or Stainless Steel

Integral Flow Check (IFC®):
Body, Plunger.....Acetal
O-ring Seals.....EPDM
Spring.....Stainless Steel

Stator Housing: Steel
Cartridge: Stainless Steel
Impeller: Non-Metallic
Shaft: Ceramic
Bearings: Carbon
O-Ring & Gaskets: EPDM

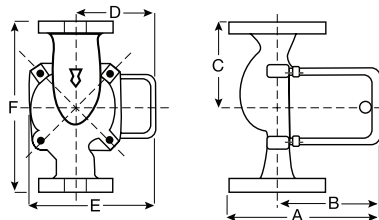

Mounting Positions

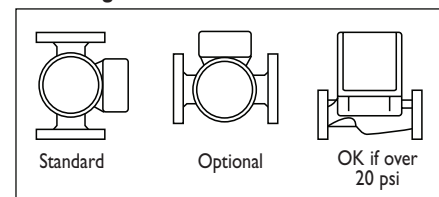

Electrical Data

Model	Volts	Hz	Ph	Amps	RPM	HP
Cast Iron	115	60	1	.71	3250	1/25
Stainless Steel	115	60	1	.76	3250	1/25
Motor Type	Permanent Split Capacitor Impedance Protected					
Motor Options	220/50/1, 220/60/1, 230/60/1, 100/110/50/60/1					

Flange Orientation

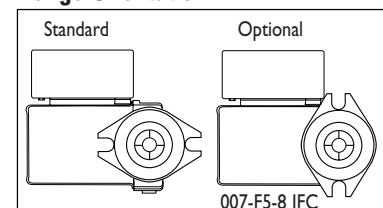

Model Nomenclature

F – Cast Iron, Flanged
SF – Stainless Steel, Flanged
IFC® – Integral Flow Check

Variations:
Z – Zoning Circulator
VR – Variable Speed Outdoor Reset
VS – Variable Speed Set Point
VV – Variable Speed Variable Voltage
J – Bronze Cartridge with Cast Iron Casing

Performance Data

Flow Range: 0 - 17 GPM
Head Range: 0 - 8.5 Feet
Minimum Fluid Temperature: 40°F (4°C)
Maximum Fluid Temperature: 230°F (110°C)
Maximum Working Pressure: 125 psi
Connection Sizes: 3/4", 1", 1-1/4", 1-1/2" Flanged



FOR INDOOR USE ONLY

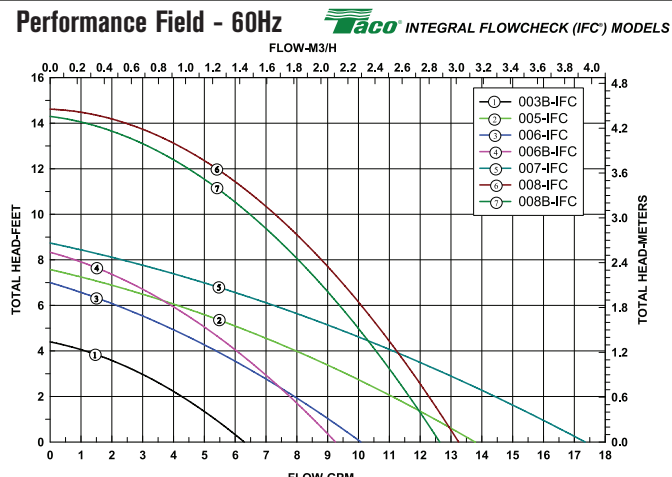

Certified to
NSF/ANSI/CAN
61

NSF® ≤ .25% Lead

Complies with California
Health and Safety Code
Section 116875 / AB1953
and Vermont Act 193

Taco Comfort Solutions A Taco Group Company

Taco, Inc., 1160 Cranston Street, Cranston, RI 02920 | Tel: (401) 942-8000

Taco (Canada), Ltd., 8450 Lawson Road, Suite #3, Milton, Ontario L9T 0J8 | Tel: (905) 564-9422

Visit our web site: www.TacoComfort.com | Printed in USA | ©2015 Taco, Inc.

