



Submittal Data Information

101-082

Model 003-IFC Cartridge Circulator

Effective: November 29, 2024

Supersedes: March 29, 2017

Job: _____ Engineer: _____ Contractor: _____ Rep: _____

ITEM NO.	MODEL NO.	

Features

- Integral Flow Check (IFC®)
Patent #5,664,939
Prevents gravity flow / reverse flow
Eliminates separate in-line flow check
Reduces installed cost
Improves system performance
Easy to service
- Unique replaceable cartridge -
Field serviceable
- Unmatched reliability-Maintenance free
- Quiet, efficient operation
- Self lubricating, No mechanical seal
- Wide range of applications
- Bronze 1/2", 3/4" sweat or Stainless Steel
with union connections

Materials of Construction

Casing (Volute): Low-lead Bronze or Stainless Steel
Integral Flow Check (IFC®):
Body, Plunger.....Acetal
O-ring Seals.....EPDM
SpringStainless Steel
Stator housing:.....Steel
Cartridge:.....Stainless Steel
Impeller:Non-metallic
Shaft:.....Ceramic
Bearings:.....Carbon
O-Ring & Gaskets:.....EPDM - Chlorine resistant

Model Nomenclature

BC – Bronze, panel mount tappings
SC – Stainless Steel, union connection,
panel mount tappings
IFC– Integral Flow Check

Performance Data

Flow Range: 0 - 6 GPM
Head Range: 0 - 4.5 Feet
Minimum Fluid Temperature: 40°F (4°C)
Maximum Fluid Temperature: 220°F (104°C)
Maximum Working Pressure: 125 psi
Connection sizes: 1/2", 3/4" sweat or union

Certifications & Listings

UL LISTED FOR INDOOR
USE ONLY

NSF Low-Lead Compliant
Certified to NSF/ANSI CAN 61 & 372

Application

- Domestic Hot Water Recirculation
- Hydro-Air Fan Coils
- Heat Recovery Units
- Water Source Heat Pumps
- Potable Water Systems

The 003-IFC with an Integral Flow Check (IFC®) is designed for the circulation of hot or chilled fresh water in open or closed loop applications. The IFC feature simplifies piping, eliminates separate in-line flow check, reduces installation costs and improves system performance. With its patented location at the impeller inlet*, the IFC is easy to service without removing the entire unit from system piping. The unique, replaceable cartridge contains all of the moving parts and allows for easy service instead of replacing the entire circulator.

* IFC is located in the discharge port on union connection model only

Pump Dimensions & Weights

Models	Conn.	A		B		C		D		E		F		Ship Wt.	
		in.	mm	in.	mm	in.	mm	in.	mm	in.	mm	in.	mm	lbs.	Kg
003-BC4-1 IFC	1/2" Swt.	6	152	4-7/8	124	2-3/16	56	2-15/16	75	3-5/16	84	4-3/8	111	6.0	2.7
003-BC4-IFC	3/4" Swt.	6	152	4-7/8	124	2-3/16	56	2-15/16	75	3-5/16	84	4-3/8	111	6.0	2.7
003-SC4-IFC	Union	6	152	4-7/8	124	2-3/16	56	2-15/16	75	3-5/16	84	5-15/16	151	6.0	2.7

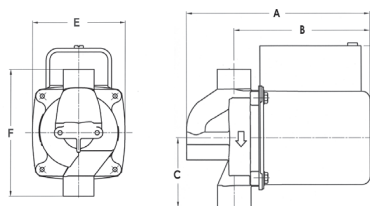

Mounting Positions

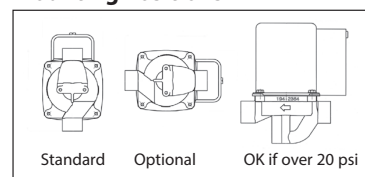

Electrical Data

Model	Volts	Hz	Ph	Amps	RPM	HP
All 003 Models	115	60	1	.45	3250	1/40
Motor Type	Permanent Split Capacitor Impedance Protected					
Motor Options	220/50/1, 220/60/1, 230/60/1, 100/110/50/60/1					

Performance Field - 60Hz INTEGRAL FLOWCHECK (IFC®) MODELS

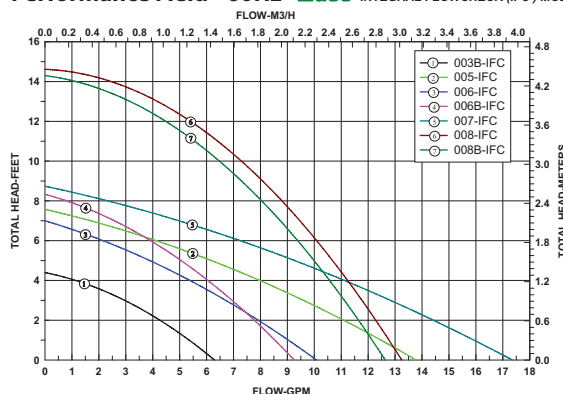

Taco Inc., 1160 Cranston Street, Cranston, RI 02920 / (401) 942-8000
Taco (Canada) Ltd., 8450 Lawson Road, Unit #3, Milton, Ontario L9T 0J8 / (905) 564-9422