

## Taco CBEs

EFFECTIVE: MARCH 20, 2017

SUPERSEDES: NEW



### TABLE OF CONTENTS

Mounting .....	2
Connections .....	3
General .....	3
Threaded connections.....	4
Allowable Connection Loads for Pipe Assembly Conditions.....	4
Soldering Connections .....	5
Soldering Procedure .....	5
Welding Connections .....	6
Strainers.....	6
Insulation .....	6
Installation of CBEs in Different Applications .....	7
Single-Phase Applications, e.g. Water/Water or Water/Oil.....	7
Refrigerant Applications in General .....	8
Refrigerant Applications and Evaporators; V-Type CBEs, e.g. V27 or V45 .....	8
Refrigerant Applications and Expansion Valves .....	8
Refrigerant Applications and Freezing Protection - To prevent freezing .....	9
Cleaning of the CBEs .....	9
Warranty .....	11

## **Mounting**

Never expose the unit to pulsations or excessive cyclic pressure or temperature changes. It is also important that no vibrations are transferred to the heat exchanger. If there is a risk of this, install vibration absorbers. In the case of larger connection diameters, we advise you to use an expanding device in the pipeline. Use e.g. a rubber mounting strip as a buffer between the CBE and the mounting clamp.

In single-phase applications such as e.g. water to water or water to oil, the mounting direction has little or no effect on the performance of the heat exchanger, but in two-phase applications, the orientation of the heat exchanger becomes very important. In two-phase applications, Taco's CBEs should be mounted vertically, with the arrow on the front plate pointing upwards.

Several mounting suggestions for Taco Inc. CBEs are shown below. Mounting stud bolts, in different versions and locations, are available on the CBEs as an option.

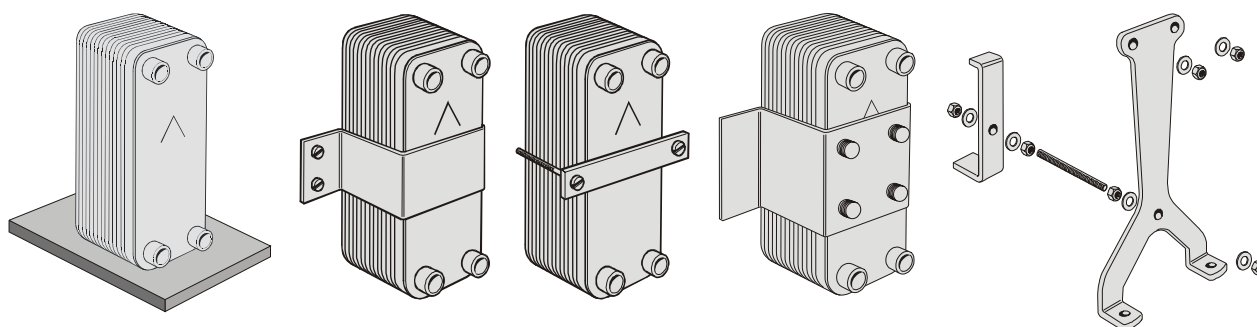

Supported from the bottom

Sheet metal bracket (rubber insert between bracket and exchanger)

Crossbar and bolts (rubber insert between the crossbar and exchanger)

Equipped with mounting stud bolts on the front or back cover plate

Support legs are available for some CBEs

For smaller CBEs it is also possible to mount the unit by simply suspending it from the pipes/connections.

## Connections

### General

All connections are brazed to the heat exchanger in the general vacuum brazing cycle, a process which gives a very strong seal between the connection and the cover plate. However, take care not to join the counterpart with such force that the connection is damaged.

Depending on application, there are a lot of options available for the connections, different versions and locations, e.g. Compac® flanges, SAE flanges, Rotalock, Victualic, threaded connections and welding connections. It is important to have the right international or local standard of connection, as they not always are compatible.

Rotalock Connections

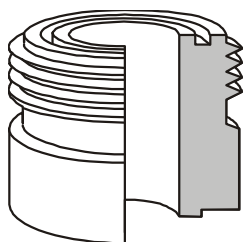

Victualic Connections

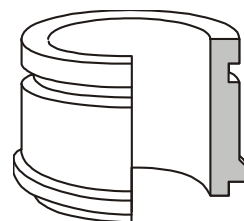

Welding Connections

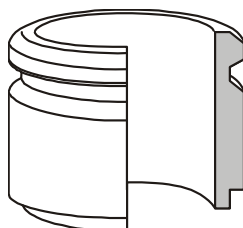

Flanges of DIN Type,  
Compac® flanges

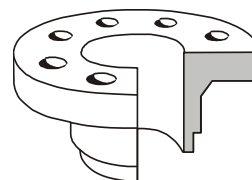

Flanges of SAE Type

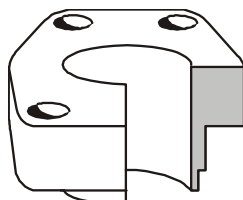

SAE O-Ring  
Connections

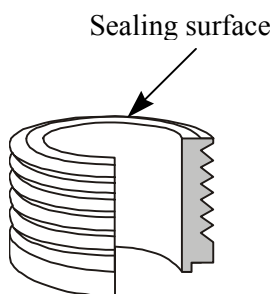
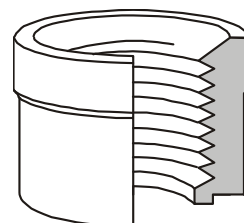

Some connections have an external heel. The purpose of the heel is to simplify the pressure and leakage testing of the CBE in production.

Some connections are equipped with a special plastic cap to protect the threads and sealing surface of the connection and to prevent dirt and dust from entering the CBE. This plastic cap should be removed with care, in order not to damage the thread or any other part of the connection. Use a screwdriver, pliers or knife.

## Threaded connections

Threaded connections can be female or male of well-known standards such as, ISO-G, NPT and ISO 7/1. The exterior can also be hexagonal which is shown below.

Externally Threaded Connections (Male)

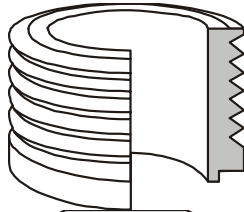

Internally Threaded Connections (Female) of Standard Type

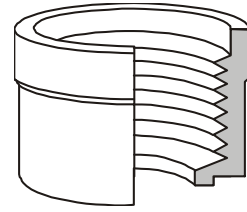

Internally Threaded Connections (Female) with a Hexagonal Exterior

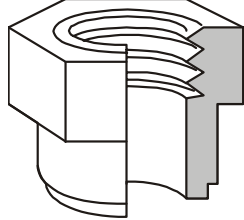

## Allowable Connection Loads for Pipe Assembly Conditions

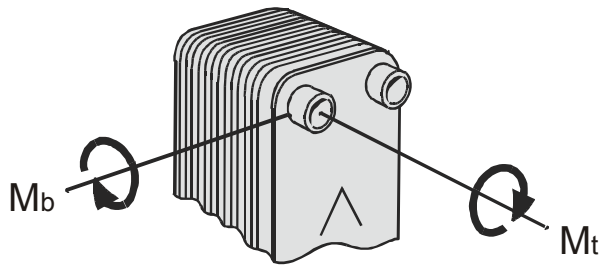

The maximum allowable connection loads given below are valid for low-cycle fatigue. The maximum allowable connection loads given below are valid for low cycle fatigue. If high cycle fatigue is involved special analysis should be made

Pipe Size	Shear Force, $F_s$		Tension Force, $F_t$		Bending Moment, $M_b$		Torque, $M_t$	
	(kN)	(kp)	(kN)	(kp)	(Nm)	(kpm)	(Nm)	(kpm)
$\frac{1}{2}$ "	7	0.7	5	0.5	40	4	70	7
$\frac{3}{4}$ "	24	2.4	5	0.5	40	4	230	23
1"	23	2.3	8	0.8	90	9	310	32
1 $\frac{1}{4}$ "	29	3.0	13	1.3	175	18	530	54
1 $\frac{1}{2}$ "	33	3.4	19	1.9	310	32	700	71
2"	43	4.4	27	2.8	510	52	1200	122
2 $\frac{1}{2}$ "	89	9.1	36	3.7	780	80	2900	296
4"	146	14.9	82	8.4	2700	277	8100	827

## Soldering Connections

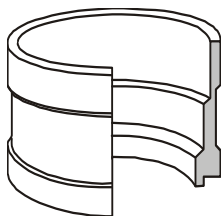

The soldering connections (sweat connections) are in principle designed for pipes with dimensions in mm or inches. The measurements correspond to the internal diameter of the connections. Some of Taco's soldering connections are universal, i.e. fit both the mm and inch pipes. These are denominated xxU, such as the 28U which fits both the 1 1/8" and 28.75 mm.

All CBEs are vacuum-brazed with either a pure copper filler or a nickel-based filler. Under normal soldering conditions (no vacuum), the temperature should not exceed 1470°F (800°C). Too much heat could change the material structure resulting in internal or external leakage at the connection. Because of this we recommend that all soldering is made with silver solder containing min. 45% silver. This type of solder has a relatively low soldering temperature and high moistening and fluidity properties.

When soldering flux is used in order to remove oxides from the metal surface. This property makes the flux potentially very aggressive. Consequently, it is very important to use the correct amount of flux. Too much, might lead to severe corrosion, so no flux should be allowed to enter the CBE.

## Soldering Procedure

The hard silver soldering procedure for all CBE connections can be carried out without any use of cooling water, neither by dimpling under water nor e.g. water flow through the waterside of the exchanger.

1. Clean the joints to be soldered. Clean the inside of the connection on the CBE and the outside of the pipe. Degrease the connection properly with some kind of solvent, e.g. Tri.
2. Apply flux to the inside of the connection and the outside of the pipe.
3. Center the pipe into the connection.
4. Avoid oxidation on the inside of the pipe by sending a flow of nitrogen through the pipe and the CBE during the soldering process.
5. It is important that the connection and the pipe are evenly heated.
6. At the correct soldering temperature (1112° F) the connection has a slightly red color.
7. The first part of the collings is done by keeping the nitrogen flowing through the exchanger. The final cooling could be done with water which removes the last hardened flux on the inside and outside around the solder.

The minimal compound of silver must be at least 45%. Below you find an example of such a solder.

**Tab. 2 Solder and flux**

Compound (%)				Melting range °C
Ag	Cu	Cd	Zn	

Hard silver solder: 454 Flux: 800 F	45	15	24	16	620-635 600-800
--	----	----	----	----	--------------------

## **Welding Connections**

Welding is only recommended on specially designed welding connections. All Taco's welding connections are executed with a 30° chamfer on top of the connection. Do not weld on pipes on other types of connections. The measurement in mm corresponds to the external diameter of the connection.

### **Welding Procedure**

Protect the unit from excessive heating by:

- using a wet cloth around the connection.
- making a chamfer on the joining tube and connection edges as shown.

Use TIG or MIG/MAG welding. When using electrical welding circuits, connect the ground terminal to the joining tube, not to the back of the plate package.

Internal oxidation can be reduced by a small nitrogen flow.

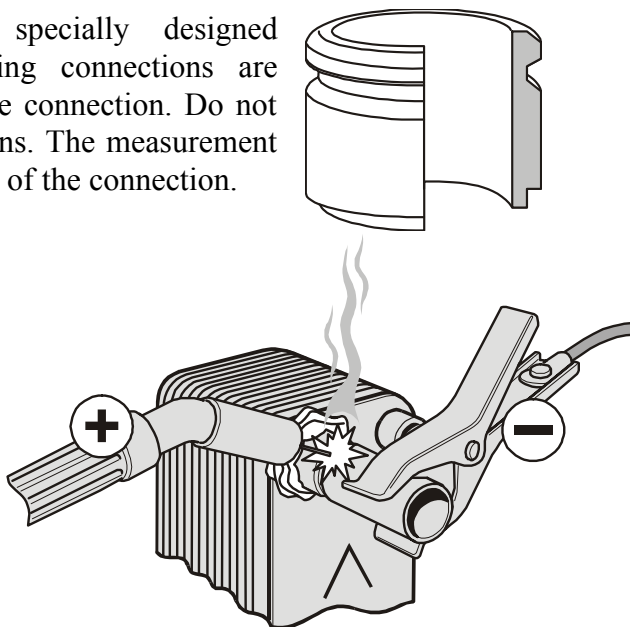

## **Strainers**

If any of the media contains particles larger than 1 mm, we recommend that a strainer be installed before the exchanger with a size of 16-20 mesh (number of openings per inch). The particles could otherwise block the channels, causing bad performance, increased pressure drop and risk of freezing. Some strainers can be ordered as CBE accessories.

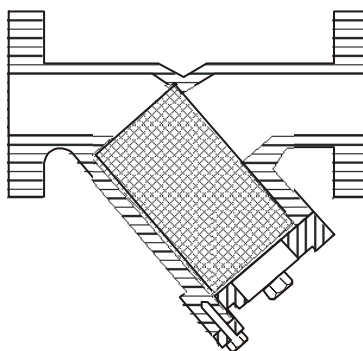
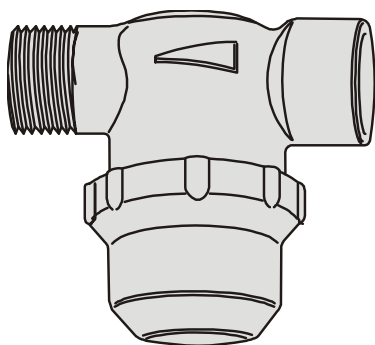

## **Insulation**

## Insulation for Refrigerant Applications

CBE insulation is recommended for evaporators, condensers or district heating applications, etc. For refrigeration, use extruded insulation sheets, e.g. Armaflex or equivalent which also can be supplied by Taco Inc..

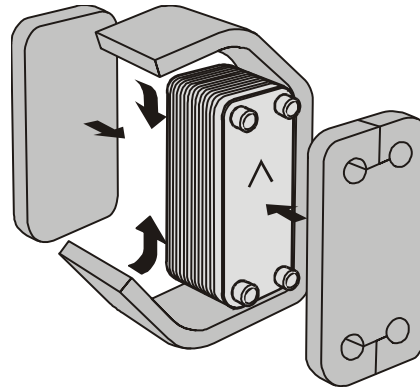

## Insulation for Heating Applications

For heating applications, various types of insulation boxes can be used. The working temperature range defines which insulation is recommended. Taco Inc. can supply some of these insulation types as optional accessories.

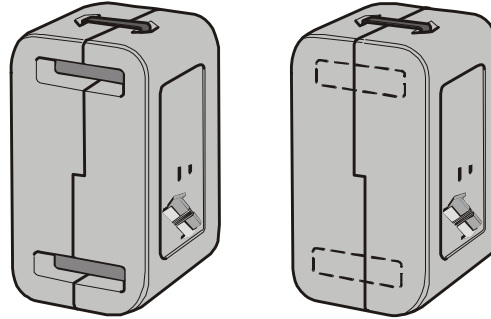

## Installation of CBEs in Different Applications

### Single-Phase Applications, e.g. Water/Water or Water/Oil

Normally, the circuit with the highest temperature and/or pressure should be connected on the left side of the heat exchanger when the arrow is pointing upwards. For example, in a typical water-to-water application, the two fluids are connected in a counter-current flow, i.e. the hot water inlet in connection F1, outlet F3, cold water inlet F4, outlet F2. This is because the right-hand side of the heat exchanger contains one channel more than the left-hand side, and the hot medium is thus surrounded by the cold medium to prevent heat loss.

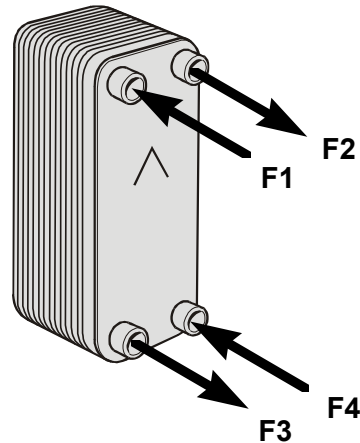

For V-type CBEs, the pressure drop in the internal distribution system must be added to the pressure drop in the expansion valve to arrive at the total pressure drop. Normally, selecting the next larger size valve will give satisfactory performance.

### Refrigerant Applications and Freezing Protection - To prevent freezing

- Use a filter < 1 mm, 16 mesh (see previous chapter on Strainers).
- Use an antifreeze when the evaporation temperature is close to liquid-side freezing.
- Use a freeze protection thermostat and flow switch to guarantee a constant water flow before, during and after compressor operation.
- Avoid the “pump-down” function.
- When starting up a system, wait a moment before starting the condenser (or have reduced flow through it).

#### Refrigerant Applications and Condensers

The refrigerant (gas) should be connected to the upper left connection, F1, and the condensate to the lower left connection, F3. The water/brine circuit inlet should be connected to the lower right connection, F4, and the outlet to the upper right connection, F2.

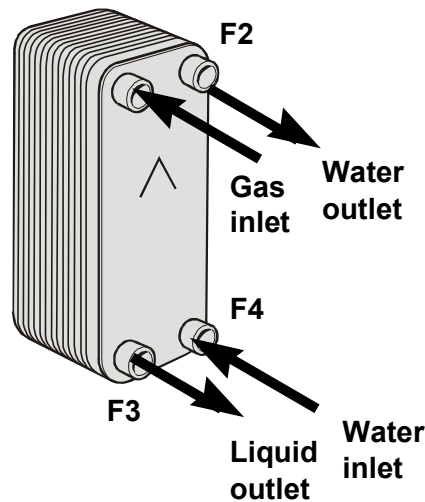

### Cleaning of the CBEs

Thanks to the normally very high degree of turbulence in CBEs there is a self-cleaning effect in the channels. However, in some applications the fouling tendency can be very high, e.g. when using extremely hard water at high temperatures. In such cases it is always possible to clean the exchanger by circulating a cleaning liquid (CIP - Cleaning In Place). Use a tank with weak acid, 5% phosphoric acid or, if the exchanger is frequently cleaned, 5% oxalic acid. Pump the cleaning liquid through the exchanger.



For V-type CBEs, the pressure drop in the internal distribution system must be added to the pressure drop in the expansion valve to arrive at the total pressure drop. Normally, selecting the next larger size valve will give satisfactory performance.

### Refrigerant Applications and Freezing Protection - To prevent freezing

- a) Use a filter < 1 mm, 16 mesh (see previous chapter on Strainers).
- b) Use an antifreeze when the evaporation temperature is close to liquid-side freezing.
- c) Use a freeze protection thermostat and flow switch to guarantee a constant water flow before, during and after compressor operation.
- d) Avoid the “pump-down” function.
- e) When starting up a system, wait a moment before starting the condenser (or have reduced flow through it).

#### Refrigerant Applications and Condensers

The refrigerant (gas) should be connected to the upper left connection, F1, and the condensate to the lower left connection, F3. The water/brine circuit inlet should be connected to the lower right connection, F4, and the outlet to the upper right connection, F2.

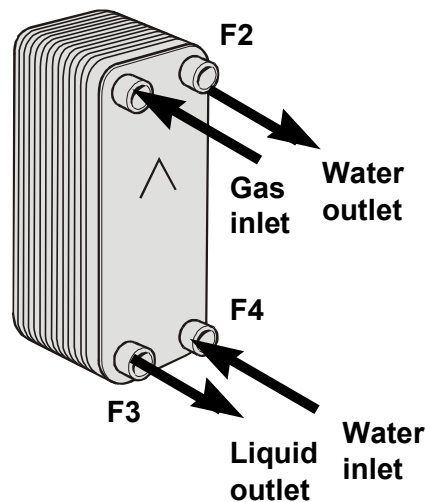

### Cleaning of the CBEs

Thanks to the normally very high degree of turbulence in CBEs there is a self-cleaning effect in the channels. However, in some applications the fouling tendency can be very high, e.g. when using extremely hard water at high temperatures. In such cases it is always possible to clean the exchanger by circulating a cleaning liquid (CIP - Cleaning In Place). Use a tank with weak acid, 5% phosphoric acid or, if the exchanger is frequently cleaned, 5% oxalic acid. Pump the cleaning liquid through the exchanger.

For tough installations we recommend factory-installed CIP connections/valves for easy maintenance.

For optimum cleaning, the cleaning solution flow rate should be a minimum of 1.5 times the normal flow rate, preferably in a back-flush mode. After use, do not forget to rinse the heat exchanger carefully with clean water. A solution of 1-2% sodium hydroxide (NaOH) or sodium bicarbonate ( $\text{NaHCO}_3$ ) before the last rinse ensures that all acid is neutralized. Clean at regular intervals

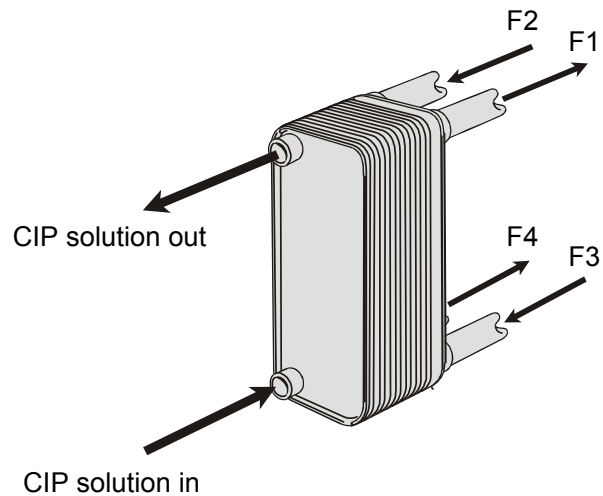

For further information, please consult Taco's technical information or your Taco representative.

## LIMITED WARRANTY STATEMENT

Taco, Inc. will repair or replace without charge (at the company's option) any product or part which is proven defective under normal use within one (1) year from the date of start-up or one (1) year and six (6) months from date of shipment (whichever occurs first).

In order to obtain service under this warranty, it is the responsibility of the purchaser to promptly notify the local Taco stocking distributor or Taco in writing and promptly deliver the subject product or part, delivery prepaid, to the stocking distributor. For assistance on warranty returns, the purchaser may either contact the local Taco stocking distributor or Taco. If the subject product or part contains no defect as covered in this warranty, the purchaser will be billed for parts and labor charges in effect at time of factory examination and repair.

Any Taco product or part not installed or operated in conformity with Taco instructions or which has been subject to misuse, misapplication, the addition of petroleum-based fluids or certain chemical

additives to the systems, or other abuse, will not be covered by this warranty.

If in doubt as to whether a particular substance is suitable for use with a Taco product or part, or for any application restrictions, consult the applicable Taco instruction sheets or contact Taco at (401-942-8000).

Taco reserves the right to provide replacement products and parts which are substantially similar in design and functionally equivalent to the defective product or part. Taco reserves the right to make changes in details of design, construction, or arrangement of materials of its products without notification.

**TACO OFFERS THIS WARRANTY IN LIEU OF ALL OTHER EXPRESS WARRANTIES. ANY WARRANTY IMPLIED BY LAW INCLUDING WARRANTIES OF MERCHANTABILITY OR FITNESS IS IN EFFECT ONLY FOR THE DURATION OF THE EXPRESS WARRANTY SET**

**FORTH IN THE FIRST PARAGRAPH ABOVE.**

**THE ABOVE WARRANTIES ARE IN LIEU OF ALL OTHER WARRANTIES, EXPRESS OR STATUTORY, OR ANY OTHER WARRANTY OBLIGATION ON THE PART OF TACO.**

**TACO WILL NOT BE LIABLE FOR ANY SPECIAL, INCIDENTAL, INDIRECT OR CONSEQUENTIAL DAMAGES RESULTING FROM THE USE OF ITS PRODUCTS OR ANY INCIDENTAL COSTS OF REMOVING OR REPLACING DEFECTIVE PRODUCTS.**

This warranty gives the purchaser specific rights, and the purchaser may have other rights which vary from state to state. Some states do not allow limitations on how long an implied warranty lasts or on the exclusion of incidental or consequential damages, so these limitations or exclusions may not apply to you.



**Taco Comfort Solutions®** A Taco Family Company

**Taco, Inc.**, 1160 Cranston Street, Cranston, RI 02920 | Tel: (401) 942-8000 | FAX: (401) 942-2360

**Taco (Canada), Ltd.**, 8450 Lawson Road, Suite #3, Milton, Ontario L9T 0J8 | Tel: (905) 564-9422 | FAX: (905) 564-9436

Visit our web site: [www.TacoComfort.com](http://www.TacoComfort.com) | Printed in USA | ©2017 Taco, Inc.

